

REV	DESCRIPTION	DATE	APPR
1	INITIAL RELEASE	10/6/11	SP

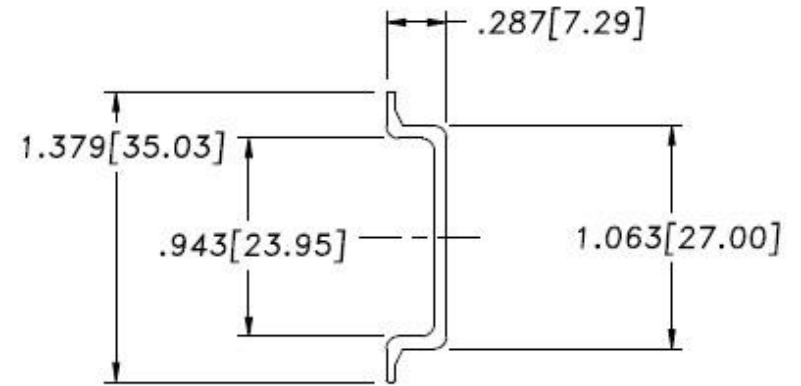
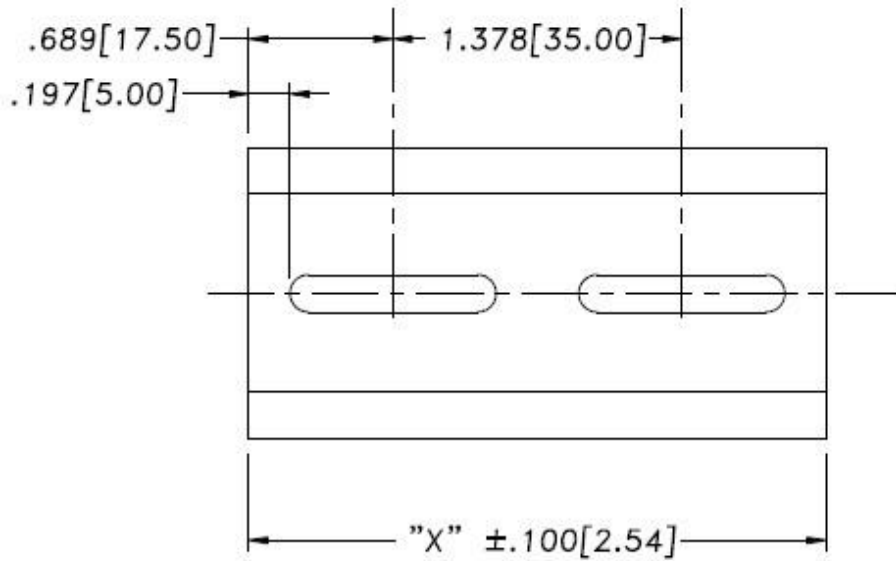

**NOTES:**

1. Material: Aluminum
2. 9 Slots , "X" Dimension 12.4" (315mm)

THE COMPONENTS, INCLUDING ANY PLATING OR COATINGS, SUPPLIED PER THIS DRAWING MUST BE COMPLIANT WITH EU DIRECTIVE 2002/95/EC (RoHS DIRECTIVE)

Unless Otherwise Specified Dimensions are in INCHES (MM)

TOLERANCES:		
DECIMALS	ANGLES	HOLE DIAMETERS
XX ± 0.1	X ± 1°	<.1 .1 TO .5 >.5
X.XX ± 0.02	X.X ± 0.5°	+ .003 +.005 +.007
X.XXX ± 0.005	X.XX ± 0.1°	-.001 -.002 -.003



693 Draper Heights Way, Suite 100  
Draper, UT 84020

**PROPRIETARY AND CONFIDENTIAL**  
THE INFORMATION DATA AND DESIGN CONTAINED HEREIN IS PROPRIETARY AND CONFIDENTIAL TO E-ZY.NET. DISCLOSURE TO EMPLOYEES AND/OR THRID PARTIES SHALL BE ON A NEED TO KNOW BASIS ONLY.

TITLE

**DIN Rail, Aluminum, 35mm x 7.5mm x 315mm**

DRAWN <b>S Parsons</b>	DATE <b>10-6-11</b>	SIZE <b>A</b>	DWG NO <b>5600033</b>	REV <b>1</b>
ENGINEER <b>S Parsons</b>	DATE <b>10-6-11</b>	Do Not Scale Drawing	COPYRIGHT © 2011 Tycon Systems	SHEET 1 of 1